

Composite Wall Panel Through Fix

Application

The JI Wall 1150 is used in controlled environments where temperature and hygiene are key factors. Main applications are therefore coldstore rooms and food processing areas.

Eurobox

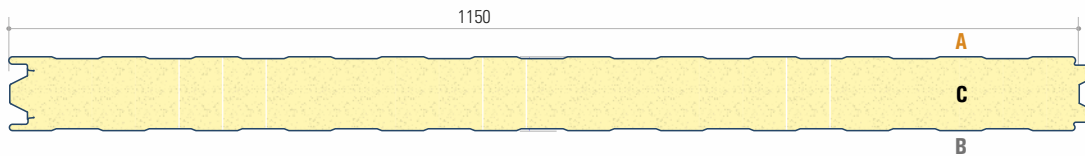

Flat

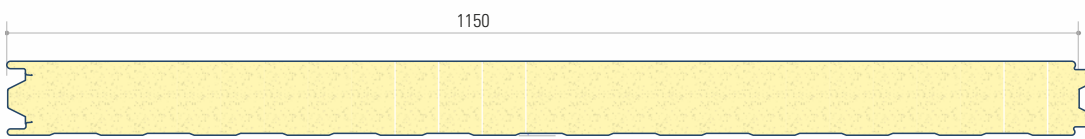

Micro

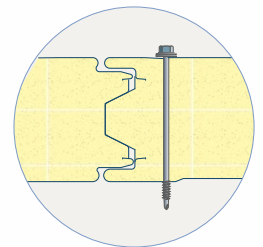
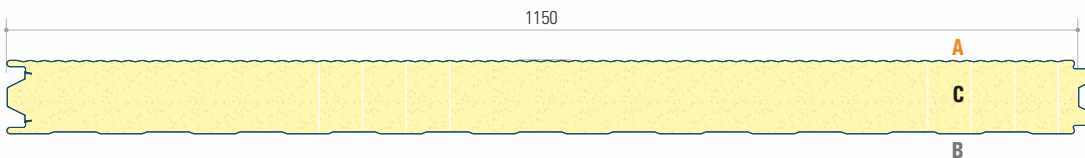

Thermal Characteristics

Core Thickness (mm)	40	60	80	100	120	150	170	200
U-Value (W/m ² .K)	0.45	0.31	0.24	0.19	0.16	0.13	0.12	0.10
Weight (kg/m ²)	10.78	11.70	12.14	12.93	13.74	14.94	15.74	16.94

U-values calculated in accordance with the method required by Part L2 (England and Wales) Building Regulations and Section 6 (Scotland) Technical Handbooks.

Product Tolerances

Length (mm)	L < 3000 mm : -5 mm L > 3000 mm : -10 mm	L < 3000 mm : +5 mm L > 3000 mm : +10 mm
Width (mm)	-2 mm	+2 mm
Thickness (mm)	-2 mm	+2 mm

Lengths

The JI Wall 1150 panel is available from 2.500 mm until 13.000 mm. Other lengths are available upon demand.

External Profiling

The outer sheet has 2 possible external finishings: eurobox or microrib 15.

Technical

Materials

Steel sheet
S280GD : Z275 – ZA265 (Zinc-Aluminum alloy)

Coatings – Outer sheet *

- PE 25 μ
- PUR 35 μ
- PVDF 25 μ
- PUR 50 μ - 60 μ
- Plastisol 200 μ HP
- Plastisol 200 μ HPS

Coating – Inner sheet

- PE 15 μ
- PE 25 μ
- Foodsafe
- Colorfarm 35 μ

* Please consult us for our colourflow

Insulation core

Polyisocyanurate (PIR) core

Fibreclass

PIR : B-s2, d0

Packaging

The panels are packed horizontally on a wooden pallet. The top and bottom of the pack is protected by polystyrene blocks to prevent damage due to handling. The number of panels per pallet depends upon the core thickness of the panel.

Core Thickness (mm)	40	60	80	100	120	150	170	200
Panels / Pallet **	16	17	13	10	8	7	6	5

** Amount reduces when panels are transported by container

Quality

The composite panels are manufactured complying to the ISO 9001 Standards. The material which are processed are from high quality and were chosen on basis of different criteria to match our customer's expectations. They proudly carry the EPAQ-label which is the European Quality Assurance Association for Panels and Profiles. All our products also have the CE-mark.

Contact

Advanced Cladding and Insulation Group, Raynes House, 3 Stokes Street, Manchester M11 4QU,
Telephone - 0161 231 0001, Email - sales@advancedcladding.com

